

# Astera AX2 PixelBar

Posted on March 8, 2021



LED Bar with built-in battery for stage, events and film lighting

Astera's Wireless PixelBar is a linear wash fixture with built-in battery pack. Each of its LEDs can be individually addressed and offers ultra-high color rendering, digital color calibration and a native 21° beam. Thanks to its smart stands, hanging bracket, connectable endcaps and the integrated airline track it can be quickly assembled in numerous ways and is suitable for a wide variety of applications such as concert/touring, corporate events, TV etc.



The PixelBar will be available in 1m (16 x 10W LEDs) and 50cm (8 x 10W LEDs).



### **Features unique to AX2 PixelBar**

#### **Talkback+**

Detect all available lights, set them up, check their status, configure DMX addresses and DMX profiles.



### **Seamless Runtime**

Set the length of your production and be sure that your lights won't run out while still getting the maximum brightness.

### **TruColor Calibration**

Individually calibrated lights lead to 100% color consistency and exact color reproduction of color temperature and filter gels.

### **Effects**

Quickly build programs out of colors and effects, trigger them or make them match a beat.

### **Flicker Free**

Scrambled PWM technology to avoid flickering when filming.



### **Green/Magenta Correction**

Adjust green/magenta during content creation to reduce postproduction work.

### **Scheduled StandBy**

Switch lights into power-saving standby and schedule them to wake up when the production starts.

### **Dynamic PowerBoost**

This exclusive feature makes the light able to display the maximum brightness at all time and

intensify non-white colors.

### **Emergency Lights**

Switches to white light when AC power is cut to keep your event save



### **Anti-Theft**

The lights give visual and audible alarm and send notification to the AsteraApp if they are being moved during an event.

### **DJ Feature**

Auto BPM analyzes the beat and matches programs to it, flash buttons can trigger special effects while being held down.



### **Other Features:**

The AsteraApp is packed with many additional items and new features are frequently added via software update.

Set the length of your production and be sure that your lights won't run out while still getting the maximum brightness.

### **TruColor Calibration**

Individually calibrated lights lead to 100% color consistency and exact color reproduction of color temperature and filter gels.

### **Effects**

Quickly build programs out of colors and effects, trigger them or make them match a beat.

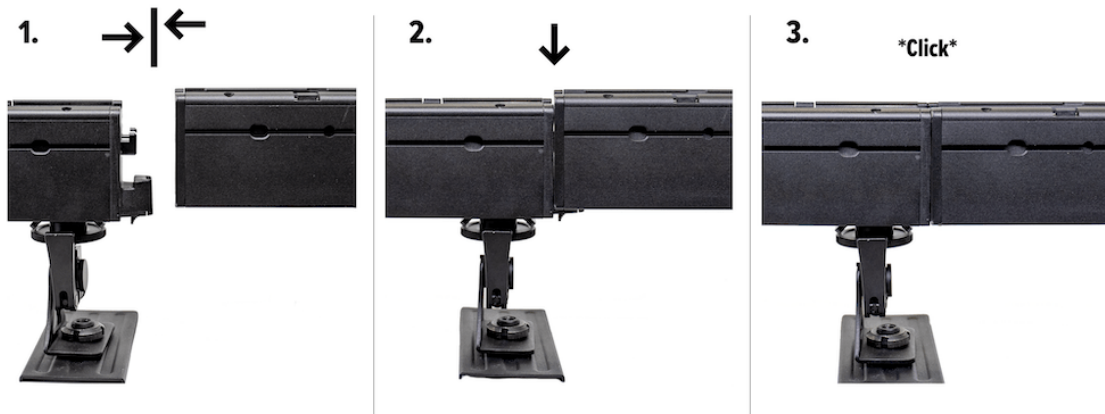

### **Flicker Free**

Scrambled PWM technology to avoid flickering when filming.

### **Green/Magenta Correction**

Adjust green/magenta during content creation to reduce postproduction work.

### **Scheduled StandBy**

Switch lights into power-saving standby and schedule them to wake up when the production starts.

### **Dynamic PowerBoost**

This exclusive feature makes the light able to display the maximum brightness at all time and intensify non-white colors.

### **Emergency Lights**

Switches to white light when AC power is cut to keep your event safe

### **Anti-Theft**

The lights give visual and audible alarm and send notification to the AsteraApp if they are being moved during an event.

### **DJ Feature**

Auto BPM analyzes the beat and matches programs to it, flash buttons can trigger special effects while being held down.





The AsteraApp is packed with many additional items and new features are frequently added via software update.

### **Optical**

Colors: Red, Green, Blue, Mint, Amber

Total LED power: 160W / 80W

Maximum power draw: 80W / 40W

TLCI (3200k-6500k)\*:  $\geq 96$

CRI (3200k-6500k)\*:  $\geq 96$

Light output - 2700k, 3200k, 5500k (100)\*: 3600lm, 4460lm, 4530lm

Light output - 2700k, 3200k, 5500k (50)\*: 1800lm, 2230lm, 2265lm

Strobe: 0-25Hz

Pixels: 16 (8)

(\*Typical value)

### **Electrical**

Battery Lifetime: 70% after 300 cycles

Battery Runtime: Up to 20 hours



Charging time (nominal): 5 Hours

Input Voltage : 110 - 240V, 50/60 Hz

### **Control**

Backside Display with HSI control

Infrared

Wireless Frequencies: CRMX 2.4GHz, UHF

Range: 300m | 330 Yards

CRMX Receiver: Built-in

### **Construction**

Housing: Aluminum

IP Rating: IP65

Operating Temperature: 0-40 °C | 32-104 °F

Weight (50): 4.5 kg (9.9 lbs)

Weight (100): 7.4 kg (16.3 lbs)

Dimensions with hook 50 (mm/inches): 520 x 165 x 65 / 20.5 x 6.5 x 2.6

Dimensions with hook 100 (mm/inches): 1020 x 165 x 65 / 40.1 x 6.5 x 2.6

Dimensions without hook 50 (mm/inches): 500 x 165 x 65 / 19.7 x 6.5 x 2.6



Astera AX2 PixelBar

Dimensions without hook 100(mm/inches):1000 x 165 x 65 / 39.4 x 6.5 x 2.6

For more information, visit: <https://astera-led.com/ax2>